

## PowerAC 7/8"-6 TA w/Bronze Nut

Call 800-321-7800 or visit us online at [www.nookindustries.com](http://www.nookindustries.com) to configure and order your PowerAC 7/8"-6 TA w/Bronze Nut today!

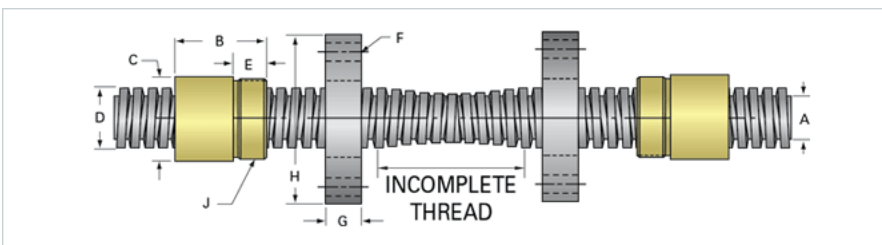
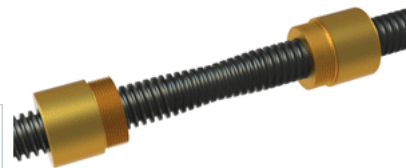

### Rolled Inch Twin-Lead Acme Screw (Twin-Lead Screw)Product Info

Screw Code	086 TA
Screw Direction	RH/LH
Screw Material	4140 Series

### (Twin-Lead Screw)Details

Lead [in]	1.000
Starts	1
Pitch [in]	0.100
Turns Per Inch	6
Threads per Inch	10
Thread Code	111
Form	Stub
End Code for Types 1,2,3,5 [* Journals may show tracings of the thread]	15
End Code for Type 4 [* Journals may show tracings of the thread]	10

### (Twin-Lead Screw)Dimensions

A - Root Diameter Minimum [in]	0.661
D - Nominal Rod Diameter [in]	0.875
Incomplete Overlapping Thread Length [in]	2.00
Maximum Overall Length [in]	72
Maximum Useable LH & RH Thread [in]	35.00

### (Twin-Lead Screw)Weight

Weight Per Foot [lb]	2.38
----------------------	------

### (Twin-Lead Screw)Part Numbers

36" Part Number	
72" Part Number	
144" Part Number	

### (Twin-Lead Screw)Performance Specifications

Lead Accuracy +/- [in/in]	0.0003
---------------------------	--------

### Inch Acme Nut with Optional Flange

#### (Nut)Product Info

Part Number	80086
Thread Direction	LH
Type	Bronze

#### (Nut)Details

Lead [in]	0.166
Starts	1
Pitch [in]	0.166
Turns Per Inch	6
Lash (Maximum Axial) [in]	0.009
Nominal Rod Diameter [in]	0.875
Threads per Inch	6
Thread Code	086
Form	2C

#### (Nut)Dimensions

B [in]	1.50
C [in]	1.50
E [in]	0.50
F (n) Dia. [in]	(4) .266
F BCD [in]	2.260
G [in]	0.52
H [in]	2.76
J [in]	1.375-16

#### (Nut)Forces and Torques

Torque to Raise 1 lb. [in-lb]	0.083
-------------------------------	-------

#### (Nut)Flange Part Numbers

Flange No-Lash Part Number	73275
Flange Part Number	FLG8281

#### (Nut)Weight

Flange Weight [lb]	0.85
Nut Weight [lb]	0.57

<b>(Nut)Performance Specifications</b>	
Efficiency [%]	32
Lead Accuracy +/- [in/in]	0.0003
Dynamic Load Capacity [lb]	3828
Static Load Capacity [lb]	12250
<b>(Nut on Other Side)Product Info</b>	
Part Number	20086
Thread Direction	RH
Type	Bronze
<b>(Nut on Other Side)Details</b>	
Lead [in]	0.166
Starts	1
Pitch [in]	0.166
Turns Per Inch	6
Lash (Maximum Axial) [in]	0.009
Nominal Rod Diameter [in]	0.875
Threads per Inch	6
Thread Code	086
Form	2C
<b>(Nut on Other Side)Dimensions</b>	
B [in]	1.50
C [in]	1.50
E [in]	0.50
F (n) Dia. [in]	(4) .266
F BCD [in]	2.260
G [in]	0.52
H [in]	2.76
J [in]	1.375-16
<b>(Nut on Other Side)Forces and Torques</b>	
Torque to Raise 1 lb. [in-lb]	0.083
<b>(Nut on Other Side)Flange Part Numbers</b>	
Flange No-Lash Part Number	73275
Flange Part Number	FLG8281
<b>(Nut on Other Side)Weight</b>	
Flange Weight [lb]	0.85
Nut Weight [lb]	0.57
<b>(Nut on Other Side)Performance Specifications</b>	
Efficiency [%]	32
Lead Accuracy +/- [in/in]	0.0003
Dynamic Load Capacity [lb]	3828
Static Load Capacity [lb]	12250