

## PowerTrac 1000 - 0200 SGT RA, with SSN Ball Nut, Preloaded,

Call 800-321-7800 or visit us online at [www.nookindustries.com](http://www.nookindustries.com) to configure and order your PowerTrac 1000 - 0200 SGT RA, with SSN Ball Nut,

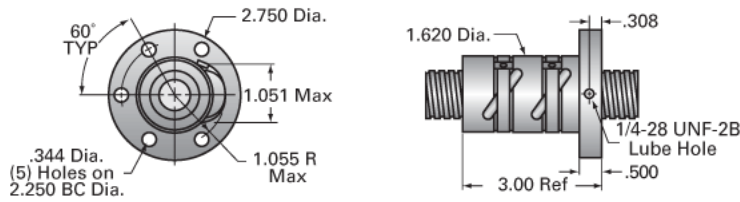

### Inch Ball Screw

#### (Screw)Product Info

Screw Code	1000-0200 SGT RA
Precision	SGT
Screw Material	4150
Thread Direction	RH

#### (Screw)Details

Ball Circle Diameter [in]	1.000
Lead [in]	0.200
Root Diameter [in]	0.865
End Code for Types 1,2,3,5 [* Journals may show tracings of the thread]	20
End Code for Type 4 [* Journals may show tracings of the thread]	12

#### (Screw)Performance Specifications

Lead Accuracy +/- [in./ft.]	0.0005
-----------------------------	--------

#### (Screw)Part Numbers

2 ft. Part Number	
4 ft. Part Number	
6 ft. Part Number	
8 ft. Part Number	GT10020R72
12 ft. Part Number	
16 ft. Part Number	
20 ft. Part Number	

#### (Screw)Weight

Screw Weight [lb./ft.]	2.20
------------------------	------

### Inch Ball Nut, for SGT, Ground Accuracy, Preloaded, Fixed, SSN

#### (Nut)Product Info

Ball Nut Number	SSN0391
Thread Direction	RH

#### (Nut)Details

Ball Circle Diameter [in]	1.000
Lead [in]	0.200
Nominal Ball Diameter [in]	0.125
Root diameter [in]	0.865

#### (Nut)Forces and Torques

Torque to Raise 1 lb. [in-lb]	0.035
-------------------------------	-------

#### (Nut)Flange Part Numbers

Flange Part Number	INTEGRAL
--------------------	----------

#### (Nut)Wiper Part Numbers

Wiper Kit Part Number	ELASTOMER
-----------------------	-----------

#### (Nut)Weight

Nut Weight [lb]	1.50
-----------------	------

#### (Nut)Performance Specifications

Maximum Adjustable Preload [lb]	
Spring Rate x 10 <sup>6</sup> [lb./in.]	3.50
Dynamic Load [lb]	1565
Static Load [lb]	13073